



RESPONSIVENESS • QUALITY • INTEGRITY • SERVICE

AE ANDERSEN ENVIRONMENTAL

Andersen Environmental is a full service consulting firm that is comprised of leading environmental professionals dedicated to providing effective solutions for our clients' environmental needs. Andersen Environmental's corporate headquarters are located in Los Angeles, California, with offices throughout the United States.

www.AndersenEnviro.com

Our Commitment



AE ANDERSEN ENVIRONMENTAL



RESPONSIVENESS

Andersen Environmental understands that a timely response to our clients' needs is a critical part of business. Andersen Environmental is committed to providing our clients with prompt response and on-time project completion.



QUALITY

Andersen Environmental is determined to provide our clients with the highest quality of consulting services, utilizing experienced and certified professionals, state of the art equipment, and steadfast professionalism.



INTEGRITY

Andersen Environmental is committed to conducting work in an ethical manner - providing accurate and reliable information.



SERVICE

Andersen Environmental will oversee all aspects of a project providing "turn-key" solutions to our clients' environmental needs.

Our professional staff is available to conduct educational presentations to your office or association, on any service we provide.

Environmental Due Diligence

PHASE I/Environmental Site Assessment

A Phase I Environmental Site Assessment is an analysis of a property's past and current usage and will outline environmental conditions that may pose a liability for the purchaser of real property. The Phase I report is conducted to the most recent ASTM and All Appropriate Inquiry (AAI) standard, as specified by the United States Environmental Protection Agency (EPA).

A Phase I assessment includes:

- Site Inspection and Interviews by an environmental professional
- Regulatory database search, review of historical resources,
Report including Conclusions and Recommendations

**Proactive Sellers:
A Phase I can be beneficial
to the marketing of a
property and also can
relieve hindrances to the
escrow process.**



SUBSURFACE INVESTIGATION

At times, the Phase I report may indicate that there is an existing or potential concern for environmental impact to a property; in such cases a subsurface investigation (Phase II) may be recommended. Such investigations consist of sampling of soil, water, or vapor in order to identify the existence of any subsurface impact.

- Develop scope of work and methodology
- Soil, water and vapor sampling
- Work within local regulatory standards and guidelines
- Interpretation of data with conclusions and recommendations

REMEDIATION

Andersen Environmental's certified professionals provide turn-key solutions to resolve contamination issues faced by clients. AE will work with clients in developing the most effective method in resolving said issues, taking into account the client's time and monetary constraints. Below is a list of common remediation (Phase III) options, although AE may develop other site-specific options.

- Soil Excavation, Removal, and Disposal
- In - Situ Remediation
- Vapor Extraction, Air Sparging
- Biological Enhancement
- Chemical Oxidation
- Groundwater Remediation Pump and Treat Systems
- Portable Treatment Systems





OTHER DUE DILIGENCE SERVICES

PROPERTY CONDITION ASSESSMENT (PCA)

Survey of physical condition of property and assessment of deferred maintenance

VAPOR INTRUSION STUDIES

Evaluation and mitigation of subsurface vapor intrusion to indoor air

GEOTECHNICAL & SEISMIC

Sampling and testing of soil for engineering and planning purposes

LAND TITLE SURVEY (ALTA / ACSM)

Land title survey as adapted by the American Land Title Association and the American Congress of Survey & Mapping

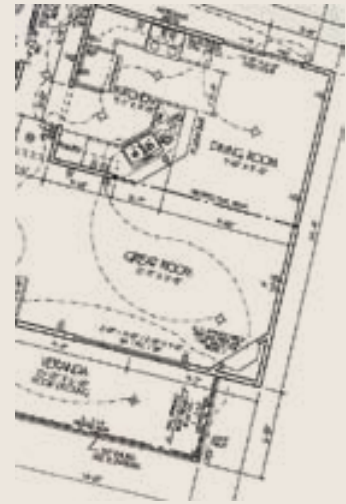

ADDITIONAL ENVIRONMENTAL SERVICES

CEQA/NEPA

Andersen Environmental provides California Environmental Quality Act and National Environmental Policy Act compliance support including documentation, and regulatory representation

GEOPHYSICAL SURVEYS

Non-invasive investigation of underground structures, USTs, utilities, geologic conditions using Ground Penetrating radar (GPR), Magnetometry, and Seismic Refractions, etc.

UNDERGROUND STORAGE TANK (UST), CLARIFIERS, AND OTHER SUBSURFACE CONTAINERS

Full service removal and closure procedures in accordance with specified regulations.

HAZARDOUS WASTE AND MATERIALS MANAGEMENT

Characterization, removal, and disposal of hazardous, and non-hazardous materials according to current federal and state regulations.

STORM WATER POLLUTION PREVENTION PROGRAM (SWPPP)

Construction site and existing facilities run-off management.



**Andersen Environmental
can assist in obtaining
State and Federal Funding
for investigation and
remediation of qualifying
properties.**

Environmental Health and Safety



ASBESTOS AND LEAD

Andersen Environmental provides the following asbestos and lead related services, custom tailored for each project:

- AHERA and NESHAP asbestos inspections
- Procedure 5 emergency asbestos abatement work plans
- On-site asbestos air sample analysis
- On-site abatement monitoring
- Lead inspections and hazard assessments
- Waste stream characterization sampling and guidance

MOLD

Mold growth is usually the result of sustained moisture intrusion from floods, leaks, or humidity. Andersen Environmental provides the following mold related services custom tailored for each project:

- The latest sampling techniques for airborne and surface mold
- Documentation detailing damage
- Report preparation including remediation work plans
- Infrared thermal imaging moisture inspections
- Clearance sampling and documentation

**24 hour field emergency
response is available
for events requiring
immediate attention.**

METHANE TESTING

Andersen Environmental provides complete methane testing for any site. Andersen Environmental is certified by the City of Los Angeles Dept. of Building and Safety as a Methane Testing Agency (cert # TA10207)

RADON

Andersen Environmental provides testing for Radon gas utilizing certified radon measurement providers. In addition, a certified consultant is able to provide a remediation plan.





ANDERSEN ENVIRONMENTAL

PROFESSIONALS

- Certified Industrial Hygienists
- Certified Asbestos Consultants
- Lead Inspectors
- Lead Project Monitors
- Professional Engineers
- Professional Geologists
- Registered Environmental Assessors
- Registered Environmental Health Specialists
- Radon Measurement Providers
- Toxicologists



PUBLIC CONTRACTING

Andersen Environmental provides contracted services for Municipal, State, and Federal agencies.

Primary NAICS: 541620, 562910,
562112, 238910, 236210,
236115, 236118, 236220

Duns: 140457750
Cage: 369Q9

Certifications: 8(a), SDB, MBE
DBE, SBE

Below are examples of organizations that Andersen Environmental has contracted with.



9937 Jefferson Blvd. • Suite 200 • Culver City • CA • 90232

TF: 888.705.6300 • Tel: 310.854.6300 • Fax: 310.854.0199

www.AndersenEnviro.com

License No. 937239